

(EERSTE RIVER ALLOTMENT AREA)  
**GENERAL PLAN NO. 1325/2018**  
 of  
**Subdivisions of Erf 9881 Eerste River**

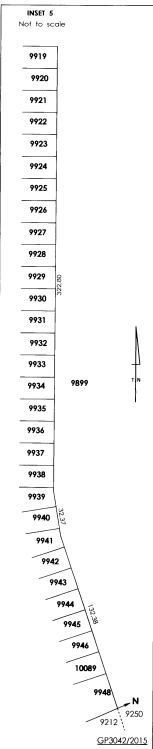

S.G. NO. 1325/2018  
 SHEET 3 OF 4 SHEETS  
 APPROVED  
*M. Clark*  
 for SURVEYOR-GENERAL  
 25.07.2018

Situate in Eerste River Industrial Township Ext.3 in the City of Cape Town  
 Administrative District of Stellenbosch  
 Province Western Cape  
 Scale: 1: 400



Notes:  
 a) For Inset 3, see Sheet 2.  
 b) For Servitude notes, see sheet 1.

Surveyed in April 2017  
 by me  
*M. Clark*  
**NA CLARK (PLS 1072)**  
 Professional Land Surveyor

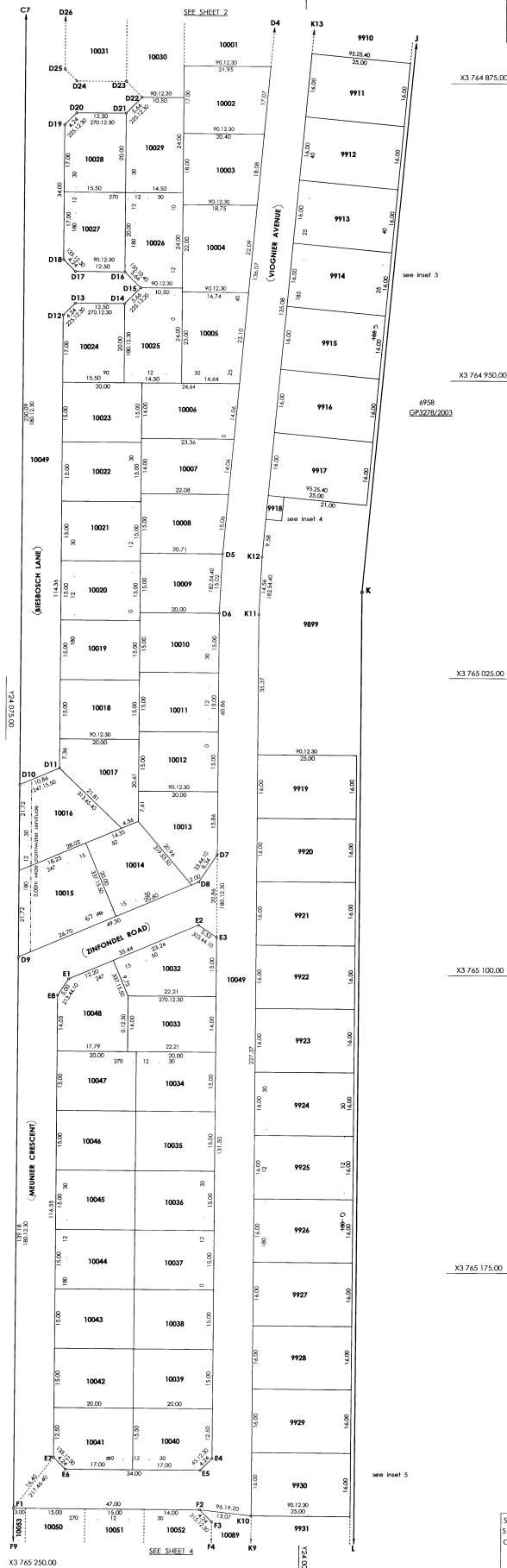

6958  
 GP 2728/2003

S.C. FILE REF: STEL 634 V.1  
 S.R.E.N.C. E 722/2018  
 COMPILATION: AHND-213(M1754)  
 AHND-21(M1769)  
 AHND-2161(M1760)  
 AHND-2163(M1763)  
 AHND-2191(M1766)

LPI\_C0670008